

No Name

106'8" (32.5 m) PRESIDENT Tri-deck

LOA:	106'8" (32.5 m)	Year:	Mfg-2009 Model-2009
Beam:	23'8" (7.2 m)	Mfg:	PRESIDENT
Draft:	Min 6' (1.8 m)	Type:	Motor Yacht Tri-Deck
Speed:		Price:	7,850,000 USD
Location:	Kaiohung, Florida, United States		

Additional Specifications For No Name:

LOA:	106'8" (32.5 m)	Year:	Mfg-2009 Model-2009
Mfg. Length:		Mfg:	PRESIDENT
Beam:	23'8" (7.2 m)	Model:	Tri-deck
Draft:	Min 6' (1.8 m)	Type:	Motor Yacht
Hull Mtrl:	FRP		Tri-Deck
Hull Cnfg.:	Semi-Displacement	Top:	With Flybridge
Hull Designer:			Sky Lounge
Deck Mtrl:	Fiberglass Sandwich	Cockpit:	
Disp:		Speed:	
Range:		Engines:	2xCaterpillar
Int Designer:			C-32 Acert
Ext Designer:			1825 HP
Fuel Cap:	4000 g (15140 l)	Engines Year:	
Water Cap:	700 g (2650 l)	Staterooms:	4
Holding Tank:		Sleeps:	8
Flag:	Grand Cayman	Heads:	5
Classifications:	Unknown	Crew Quarters:	2
Class Type:		Crew Berths:	3
MCA:		Captain Cabin:	Yes
ISM:		Price:	7,850,000 USD
Location:	Kaiochung, Florida, United States		

Accommodations and Layout

Sleeps 8 owners and guests in four staterooms. All have private baths. The crew are aft with two staterooms and two baths. A dayhead is found on the main deck level.

Experienced yachtsmen (and yachtswomen) will find this good-looking and expansive 107' tri-deck motoryacht quite intriguing. Her interior is completely paneled in satin-finished teakwood with gloss trim pieces. The countertops in the galley and baths are beige granite with black flecks. Bath flooring is marble. The décor is earth-toned with an upscale feel. Carpeting throughout is a beige woven pile. Window treatments are pleated shades.

From the aft deck, enter the salon via stainless steel-framed glass doors (Aritex) that open automatically. A sofa pit is to port with a built-in entertainment credenza to starboard (pop-up LCD television). Just forward and to starboard is an L-shaped bar with stools. To port is a dining table which seats 8 in comfort. Next is a foyer with a dayhead on the inboard side and a country-style kitchen layout, with a large settee forward.

Two sets of stairs to starboard lead down to the VIP forward (queen centerline bed, closet and bath). Three other staterooms, fore and aft sharing a foyer area, are found aft down another set of stairs off of the galley area. The ensuite guest staterooms are aft and have twin berth. The master is forward and features a centerline king-sized bed, a spacious full beam bath with a shower and Jacuzzi tub, and a cedar-lined walk-in closet to port.

Up another set of stairs on the starboard side by the main deck foyer is access to the wheelhouse. This expansive area offers an L-shaped settee to port, a wet bar aft and stbd, twin helm chairs and centerline helm area. Port and starboard wing-doors offer access to the walkaround Portuguese style bridge. Aft of the wheelhouse is a room that is currently designed as a stateroom, complete with a centerline king-sized bed, vanities, entertainment system with a pop-up television, expansive windows offering great views and a private seating area outside. This can easily be converted to a skylounge area with a convertible sofa if so desired.

From the aft deck, a stairway to port accesses the skylounge deck. From there another stairway accesses an open flybridge with a helm station, wetbar, L-shaped settee, radar arch and boat deck. The transom area is reached via twin opposing stairways (eurotransom) with access to the crew area through a watertight door.

Crew accommodations feature a lounge/mess to starboard with a twin bunk stateroom (ensuite) to starboard and a captain cabin with a queen bed and ensuite to port. Forward and to port is a foyer area and stairway leading to the aft deck through a watertight door.

Galley & Housekeeping

Galley Bar



The galley offers plenty of counter and storage space, with an L-shaped configuration. All appliances are have stainless steel facings. Oak flooring is featured in the galley and lounge area. Countertops are granite.

GE® JP950WKWW, 30" electric cook top
GE® SCA1001KSS, microwave
GE® ZISS480DRSS, side by side refrigerator
GE® ZBD0710KSS, dish washer
GE® ZEK938SFSS, built-in electric single oven
Broan® 1052B, trash compactor
U-Line® 2015WC Wine cooler, 120VAC/60HZ (2)
Insinkerator® garbage disposal
Moen Stainless steel double sink w/single lever kitchen faucet
GE® ZDIS15CDD automatic ice maker (salon bar)
Wine chiller (salon bar)
Wet bar with GE® ZIBS240PSS ref/ice maker (aft deck)
GE® ZIBS240PSS ref/ice maker (PH & FB)
U-Line® 15R Refrigerator (crew)

Kenyon® B41601 cook top (dual burner) (crew)
GE® JVM1790SK Profile microwave (crew)
Bean central vacuum system
Washer/Dryer

Engine Room & Mechanical



The engine room is accessed through a watertight door forward of the aft crew area. It is full beam with plenty of access to equipment. Aluminum diamond-plate' flooring is easily removable to access fully gel-coated bilge areas. The engine room is attractively dressed out in perforated aluminum sound shielding.

Twin Caterpillar® C-32 Acert diesel engines, 1,825 hp
ZF Gear ratio 467:1 - mounted on stainless steel beds
Racor (dual each) FG1000 fuel filter/water separators (main engines)
Racor (dual each) FG900 fuel filter/water separators (gensets)
Glendinning electronic engine controls EEC-3 (PH and FB)
Cruisair chilled-water Air conditioning system, (Total 15 Tons)
Trac® 300/12sq ft. roll fin stabilizer system
Trac® 45HP hydraulic bow thruster
Trac® 45HP hydraulic stern thruster
Groco Bronze sea water strainers with shut-offs
Headhunter® fresh water pressure system with pump (2) AC and (1) DC
SeaRecovery Watermaker (70 gph)
(2) Hot water heaters (s/s - 30usg each)
Fiberglass holding tank 120 US. Gals with lever indicator
Macerator pump (2)
Hamman® waster treatment system super mini 24V
Sump Pumps for baths (3)
Engine room fire detector
Reverso® GP705, Oil-change system for main engines and generators
Fireboy® MA2-1500-FM200, Fire extinguishing system with manual and automatic discharge

Hull & Deck Equipment

President hulls and decks are FRP (fiberglass reinforced plastic) - built using the latest methods (vacuum-bagged for weight reduction) and finest materials available. The hull is solid FRP using Hydrex vinylester resin for skin coats and sealed using International epoxy osmosis primer. The exterior finish is super-fair bright white using CCP gelcoat.

The hull design features a modified V-hull with propeller pockets and underwater type exhausts.

All decks are walkaround. The foredeck features a built-in circular settee with a table and plenty of deck storage. The aft deck features a beautiful teak table with chairs.

The exterior main deck and transom area is covered in natural Teak

Aluminum fuel tanks (paint with anti-rusting paint) - with access plates
Stainless steel 316 fresh water tank w/gauge

Maxwell® VWC - 4000HYD (hydraulic) windlasses (2) w/ hand held control & chain counters

Twin S/S navy type anchors (160 lbs each) with 1/2" HT chain, 200ft

Chain locker with fiberglass hatch

Fresh and raw water washdowns

Two Stainless steel mooring bollards forward with fairleads

S/S hawse pipe with spring cleats (4)

Rub rail with stainless steel trim

Windows are frameless style tempered glass

EXALTO® wipers (5)

Kahlenberg® D-1 dual horn with KA-500 air compressor

316 S/S stanchions & handrails

Fiberglass bulwark doors (2)

Tide-ride boarding ladder and hanging ladder

Aritex heavy-duty stainless steel exterior doors

Maxwell® VC2200 vertical electric stern capstans (2)

Aqualoy® 22HS Propeller shafts, 4" diameter

5- Blade NiBral Propellers

Transom shower hot & cold water

Shorewater connections

Steelhead® SM2000R, crane 120VAC/60HZ

Atlantica DLX 421 RIB w/60 hp Yamaha 4 stroke outboard

Platismo Liferaft (8 person)

Docklines and inflatable fenders

USCG equipment

Exterior covers

Electronics and Entertainment

CAT electronic engine displays

Furuno Navnet system with two displays in the Pilothouse (PH) and one on the Flybridge (FB). Employs black-box plotting (C-Map NT), Radar, Video Depth.

Simrad Robertson Autopilot (PH and FB)

Furuno DSC VHF (PH and FB)

Intercom(4)

Ritchie® SS5000, flush mount compass (2)

Satellite Television with Direct TV receivers

42" Pioneer LCD television with surround sound and Toshiba DVD recorder (salon)

36" Toshiba LCD television (skylounge/stateroom) pop-up

Toshiba LCD television (crew)

LCD television in weather proof enclosure (aft deck)
LCD television (wheelhouse)
Sound system with volume controls and exterior speakers

Electrical System

Northern Lights® generators with sound shield 2 set (M944W rating 30KW/60HZ and M1064D rating 40KW/60HZ).
Trace® SW4024MC2 Inverter/charger (2) with interface cable 50ft
Glendinning®,CM-8/24V.(100AMP) cable master shore power cable winder (2)
Charles® 100A A-B Selector and ISOBOOST transformer 100AMP (2) & 50A (1)
VAC and VDC distribution panels with lcd meters and thermal breakers
Sealed maintenance free battery 255AH, (8) w/FRP. Battery boxes for 24V service
Sealed maintenance free battery 105AH, (2) w/FRP. Battery boxes for 12V service
Sealed maintenance free battery 210AH, (4) w/FRP. Battery boxes for engines
Sealed maintenance free battery 105AH, (2) w/FRP. Battery boxes for generator
Emergency parallel switch between engines and service's battery bank
Battery on/off switches
Dolphin 24 and 12 VDC battery chargers (ER)
Powerline® 160A large frame 24V alternator w/regulator
Bonding system w/zinc anodes on transom
Stereo wiring w/speakers (14)
Color-coded wiring system
Interior Halogen lighting with Vimar switches and dimmers
Exterior courtesy lighting
Engine room light 24VDC (6) and 120AC fluorescent light (4)
ACR®RCL-100 remote control searchlight
Aqua -signal navigation lighting
Flood lights , mounted in aft deck overhead and P/H deck overhead
Engine room intake/exhaust blowers (4)

Remarks

This is the flagship for the new line of President tri-deck motoryachts offering huge volume and great performance in an easy-to-manage 107' length. She is built to high standards and features only the best equipment.

Galley port



Salon



Sofa



Dining Table



Master Stateroom



Bath



Walk-in Closet



Forward View



Guest Stateroom



Guest Stateroom 2



Skylounge



Aft Deck



Pilothouse



Settee



Wet Bar



Starboard view



Captains Cabin



Crew Quarters



Crew Lounge



Tenders



Dayhead



Layout

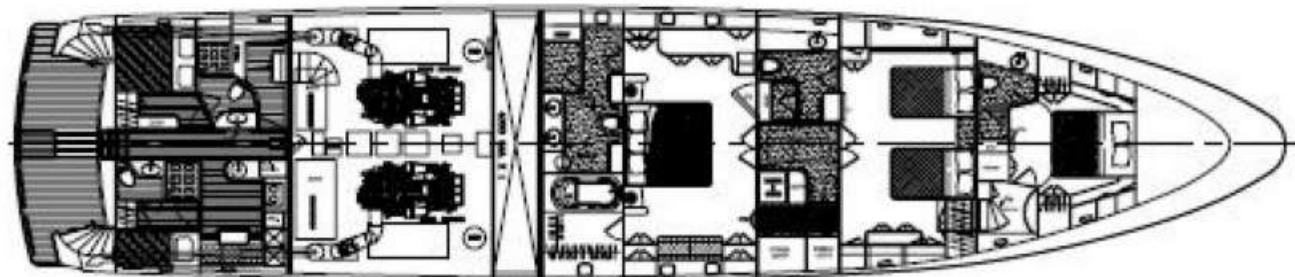

Layout

